



Full Line EC&N Catalog:  
***Elbows, Couplings & Nipples***

# We've been connecting America

*Picoma is America's leading brand of steel elbows, couplings and nipples (EC&N) and a division of Zekelman Industries, the largest independent manufacturer of steel pipe and tube in North America.*



North America's Best-in-class Electrical Elbows, Couplings & Nipples

# for over 75 years.

## Your complete EC&N package

Today, Picoma offers distributors a complete line of EMT as well as rigid steel and aluminum elbows, couplings and nipples for electrical conduit applications. With our experienced, dedicated service team, it's no surprise that Picoma has set the industry standard for decades.

## The right product, right when you need it

As the industry leader, Picoma offers in-house bending, cutting and threading capabilities with the largest selection of specialty items, including special-length nipples, long-radius elbows, and custom bending and threading for unique applications. Our specialized hot-dip and in-line galvanized products set the benchmark for quality in the industry.

Picoma products are manufactured in Cambridge, Ohio, from conduit stock produced in-house, then further fabricated and shipped to our local warehouses across North America.

## 100% Made & Melted in America

Picoma's standard line of steel EC&N satisfies the strictest American Made, Made in America and Buy American legislation, so you can buy with confidence. Offering superior physical protection for electrical conductors, Picoma is your single source for all EC&N in North America.

## Contractor-focused innovations

Innovation at Picoma starts with listening carefully to our customers' needs. Responsiveness to users is a priority at every level of the company, from the executive suite to the manufacturing floor.

For example, much of Picoma's production equipment has been specially designed or modified by Picoma engineers to meet our high, rigid quality standards, exceed industry standards and perform to precise customer requirements.

## Responsive service, helpful technology

Our fully integrated planning systems ensure steel coils and conduit feedstock are in place and available when needed, so you can expect a quick response to spikes in demand and changes in order patterns.

Our Electronic Data Interchange (EDI) program with a vendor-managed inventory (VMI) system allows you to place your order 24/7. It speeds order entry, lets you match UPC numbers, improves order and invoice accuracy, and tells you when your order will ship. Picoma offers superior fill rates (98%) and fast order turnaround.

## Strength. Innovation. Service.

We take great pride in serving our customers' needs. No job is too big for us to handle—and delivering on time is standard practice, whether it's standard EC&N or special (C&D) items. And we continually look for opportunities to bring greater value to every customer relationship through product and process innovations.



*Picoma products are listed by Underwriters Laboratories.*

**AMERICAN  
METAL**

For more information, call **800.PICOMA1** or visit **picoma.com**

# Elbows, Couplings & Nipples

## Steel Electrical Metallic Tubing

### 90°/45° ELBOWS

TRADE SIZE	UL MIN. RADIUS**	90° ELBOWS			45° ELBOWS		
		STD. CARTON QTY.	WEIGHT PER CTN. (lbs.)	WEIGHT PER 100 (lbs.)	STD. CARTON QTY.	WEIGHT PER CTN. (lbs.)	WEIGHT PER 100 (lbs.)
½	4	50	13	26	50	12	24
¾	4½	50	23	46	50	20	40
1	5¾	25	23	92	25	18	72
1¼	7¼	20	27	135	20	20	100
1½	8¼	15	30	200	15	22	147
2	9½	10	28	280	10	21	210
2½*	10½	Bulk	—	500	Bulk	—	358
3*	13	Bulk	—	750	Bulk	—	700
3½*	15	Bulk	—	1014	Bulk	—	850
4*	16	Bulk	—	1300	Bulk	—	1000

\* Trade sizes 2½ and larger shipped in palletized carton or bulk.

\*\* Minimum dimension per UL-6.

Standard-radius elbows also available in 60°, 30°, 22½°, 15° and 11¼°.

Weights are approximate.

90° and 60° elbow weights are the same. Weights for 30°, 22½°, 15° and 11¼° are the same as 45° elbows.

### SPECIAL LARGE-RADIUS 90° ELBOWS

TRADE SIZE	12" RADIUS	15" RADIUS	18" RADIUS	24" RADIUS	30" RADIUS	36" RADIUS	42" RADIUS	48" RADIUS
½	—	—	—	—	—	—	—	—
¾	—	—	—	—	—	—	—	—
1	—	—	—	—	—	—	—	—
1¼	—	—	—	5	—	—	—	—
1½	—	4	4	5	—	7	—	9
2	—	—	6	7	9	9	—	9
2½	—	—	—	11	—	13	—	—
3	—	—	—	15	15	16	—	21
3½	—	—	—	—	—	25	—	22
4	—	—	—	19	21	24	28	31

Numbers in table above represent weight in pounds of elbows we offer.



#### Tested and Listed for Safety

Our EMT elbows comply with the following standards: ANSI C80.3 and UL-797, to which they are Listed.

## Steel Rigid Metal Conduit

### COUPLINGS

TRADE SIZE	OUTSIDE DIAMETER	UL MIN. LENGTH*	WEIGHT PER 100	WEIGHT PER CTN.	STD. CTN. QTY.
	in.	in.	lbs.	lbs.	
½	1.010	1½	12	12	100
¾	1.250	1¼	18	9	50
1	1.525	1¾	30	9	30
1¼	1.869	2½	37	9	25
1½	2.155	2¼	52	13	25
2	2.650	2½	72	15	20
2½	3.250	3¾	170	41	24
3	3.870	3¾	210	34	16
3½	4.500	3¾	340	41	12
4	4.875	3¾	300	30	10
5	6.000	3¾	475	Bulk	Bulk
6	7.200	4¼	765	Bulk	Bulk

\* Minimum dimension per UL-6.

### SPECIAL LARGE-RADIUS 90° ELBOWS

TRADE SIZE	12" RADIUS	15" RADIUS	18" RADIUS	24" RADIUS	30" RADIUS	36" RADIUS	42" RADIUS	48" RADIUS	60" RADIUS
1	4	6	5	6	9	9	12	13	—
1¼	6	7	7	9	12	13	16	18	—
1½	8	9	10	11	15	16	19	21	—
2	10	10	11	14	20	22	24	26	—
2½	15	19	18	23	27	32	39	44	—
3	—	25	28	32	37	45	52	57	—
3½	—	Standard Radius	31	35	42	54	62	69	—
4	—	—	38	45	54	64	73	81	90
5	—	—	—	Standard Radius	85	94	100	120	136
6	—	—	—	—	Standard Radius	131	140	160	182

Numbers in table above represent weight in pounds of elbows we offer.



#### Tested and Listed for Safety

Our steel rigid elbows comply with the following standards: ANSI C80.1 and UL-6, to which they are Listed.

#### Chart Key

— = not available | Bulk = shipped in palletized carton or bulk

# Steel Rigid Metal Conduit

## 90° ELBOWS

TRADE SIZE	UL MIN. RADIUS**	OFFSET (FIG. 1)	UL MIN. STRAIGHT (FIG. 2)**	WEIGHT PER 100	STANDARD CARTON QTY.
	in.	in.	in.	lbs.	
½	4	5 ⅞	1 ½	70	50
¾	4 ½	7	1 ½	112	50
1	5 ¾	8 ¾	1 ⅞	192	25
1 ¼	7 ¼	10 ¾	2	320	20
1 ½	8 ¼	12 ¼	2	413	15
2	9 ½	14 ½	2	670	10
2 ½*	10 ½	17	3	1200	Bulk
3*	13	19 ⅞	3 ⅞	1900	Bulk
3 ½*	15	22 ¾	3 ¼	2800	Bulk
4*	16	23 ⅞	3 ⅞	3100	Bulk
5*	24	34 ⅞	3 ⅞	6800	Bulk
6*	30	45 ½	3 ¾	11400	Bulk

## SPEEDCOUPLE RMC 90° ELBOWS

TRADE SIZE	MIN. RADIUS	OFFSET	STRAIGHT	WEIGHT PER ELBOW	WEIGHT PER ELBOW WITH COUPLING	STD. CTN. QTY.
	in.	in.	in.	lbs.	lbs.	
2	9.5	14.54	5.04	6.70	7.58	5
2 ½	10.5	17.00	6.50	12.00	13.76	Bulk
3	13	19.67	6.67	19.00	20.98	Bulk
3 ½	15	22.72	7.72	28.00	30.65	Bulk
4	16	23.94	7.94	31.00	34.09	Bulk
5	24	34.90	10.90	68.00	71.97	Bulk
6	30	45.50	15.50	114.00	119.25	Bulk

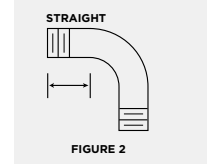
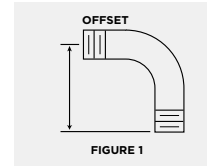

SpeedCouple elbows shall be listed to UL standards UL-6 (elbow) and UL-514B (coupling). Elbows manufactured in accordance with ANSI C80.1. Standard-radius elbows: Available in 90°, 60°, 45°, 30°, 22 ½°, 15° and 11 ¼°. Special-radius elbows: Available in 90°, 60°, 45°, 30°, 22 ½°, 15° and 11 ¼°.

\* Trade sizes 2 ½ and larger shipped in palletized cartons or bulk. Palletized and bulk elbows supplied with a thread protector on each end and UL label affixed.

\*\* Minimum dimension per UL-6.

### Tested and Listed for Safety

Our galvanized steel rigid elbows, couplings and nipples comply with the following standards: ANSI C80.1 and UL-6, to which they are Listed.



## NIPPLES

LENGTH	TRADE SIZE	LENGTH* (IN.)	CLOSE		1 ½"		2"		2 ½"		3"		3 ½"	
			STD. CARTON QTY.	WEIGHT PER 100 (LBS.)	STD. CARTON QTY.	WEIGHT PER 100 (LBS.)	STD. CARTON QTY.	WEIGHT PER 100 (LBS.)	STD. CARTON QTY.	WEIGHT PER 100 (LBS.)	STD. CARTON QTY.	WEIGHT PER 100 (LBS.)	STD. CARTON QTY.	WEIGHT PER 100 (LBS.)
½	1 ½	25	6	25	8	25	12	25	15	25	19	25	22	
¾	1 ⅞	25	9	25	9	25	14	25	19	25	24	25	28	
1	1 ½	25	16	—	—	25	22	25	28	25	36	25	43	
1 ¼	1 ⅞	25	22	—	—	25	28	25	37	25	47	25	55	
1 ½	1 ¾	25	28	—	—	25	34	25	44	25	56	25	68	
2	2	25	44	—	—	—	—	25	59	25	72	25	88	
2 ½	2 ½	12	84	—	—	—	—	—	—	10	100	10	120	
3	2 ⅞	12	118	—	—	—	—	—	—	10	130	10	157	
3 ½	2 ¾	12	160	—	—	—	—	—	—	—	—	—	—	
4	2 ⅞	12	180	—	—	—	—	—	—	—	—	—	—	
5	3	Bulk	240	—	—	—	—	—	—	—	—	—	—	
6	3 ⅞	Bulk	350	—	—	—	—	—	—	—	—	—	—	

LENGTH	TRADE SIZE	4"		5"		6"		8"		10"		12"	
		STD. CARTON QTY.	WEIGHT PER 100 (LBS.)	STD. CARTON QTY.	WEIGHT PER 100 (LBS.)	STD. CARTON QTY.	WEIGHT PER 100 (LBS.)	STD. CARTON QTY.	WEIGHT PER 100 (LBS.)	STD. CARTON QTY.	WEIGHT PER 100 (LBS.)	STD. CARTON QTY.	WEIGHT PER 100 (LBS.)
½	25	26	25	33	25	40	25	54	25	68	25	82	
¾	25	34	25	43	25	52	25	73	25	89	25	109	
1	25	49	25	64	25	78	25	109	25	138	25	166	
1 ¼	25	66	25	84	25	100	12	136	12	176	12	216	
1 ½	25	80	25	103	25	122	12	170	12	216	12	260	
2	25	103	25	132	25	160	12	220	12	285	12	335	
2 ½	10	150	12	197	12	240	5	329	5	422	5	505	
3	10	200	10	260	10	300	5	411	5	528	5	630	
3 ½	10	240	10	320	5	373	5	510	5	655	5	785	
4	10	285	10	380	5	440	5	600	5	775	5	925	
5	—	—	Bulk	480	Bulk	600	Bulk	825	Bulk	1055	Bulk	1260	
6	—	—	Bulk	660	Bulk	820	Bulk	1125	Bulk	1440	Bulk	1720	

\* Length reference is for close nipples only. Prices are available upon request for nipples in lengths longer than 12" or with special threading requirements.

# Steel Rigid Metal Conduit

## YARD-LIGHT ELBOWS

TRADE SIZE	STANDARD CARTON QTY.	WEIGHT PER 100	WEIGHT PER CTN.	DIMENSIONS (REFER TO DIAGRAM)				
				lbs.	lbs.	A (in.)	B (in.)	C (in.)
½	50	150	38	4	18	6 ⅜	2 ⅜	14
¾	40	202	51	4 ½	18	6 ¾	2 ¼	13 ½
1	25	316	79	5 ¾	18	8 ⅝	2 ⅞	12 ¼
1 ¼	10	477	48	7 ¼	19 ¼	10 ¼	3 ¼	12 ¼
1 ½	Bulk	609	—	8 ¼	20 ½	11 ⅝	3 ⅜	12 ¼
2	Bulk	911	—	9 ½	21 ½	14 ½	5	12
2 ½	Bulk	1530	—	10 ½	22 ½	16	5 ½	12
3	Bulk	2279	—	13	25	19 ¼	6 ¼	12
3 ½	Bulk	3082	—	15	27	22 ¾	7 ¾	12
4	Bulk	3799	—	16	28	24	8	12

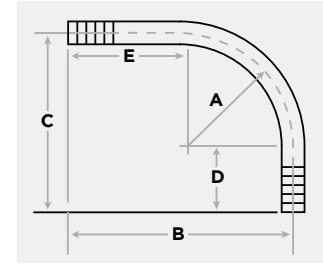

**Tested and Listed for Safety**  
Our galvanized steel rigid elbows, couplings and nipples comply with the following standards: ANSI C80.1 and UL-6, to which they are Listed.

# Rigid Aluminum Conduit

## COUPLINGS

TRADE SIZE	OUTSIDE DIAMETER	UL MIN. LENGTH*	WEIGHT PER 100	WEIGHT PER CTN.	STANDARD CARTON QTY.
	in.		lbs.	lbs.	
½	1.078	1 ⅝	6	6	100
¾	1.328	1 ¼ <sup>64</sup>	9	5	50
1	1.562	1 ¾ <sup>32</sup>	13	4	30
1 ¼	1.953	2 ½ <sup>32</sup>	19	5	25
1 ½	2.219	2 ⅞	23	6	25
2	2.750	2 ⅞	35	7	20
2 ½	3.281	3 ⅜	68	16	24
3	3.812	3 ⅝	91	15	16
3 ½	4.438	3 13 <sup>32</sup>	108	13	12
4	5.000	3 33 <sup>64</sup>	142	14	10
5	6.219	3 61 <sup>64</sup>	242	—	Bulk
6	7.312	4 ¼	320	—	Bulk

\* Minimum dimension per UL-6A.



**Tested and Certified for Safety**  
Our rigid aluminum elbows, couplings and nipples comply with the following standards: ANSI C80.5, and UL-6A, to which they are Listed.

## 90° ELBOWS

TRADE SIZE	UL MIN. RADIUS**	OFFSET (FIG. 1)	UL MIN. STRAIGHT (FIG. 2)**	WEIGHT PER 100	WEIGHT PER CTN.	STANDARD CARTON QTY.
	in.		in.	lbs.	lbs.	
½	4	5 ⅞	1 ½	26	13	50
¾	4 ½	7	1 ½	40	20	50
1	5 ¾	8 ¾	1 ⅞	72	18	25
1 ¼	7 ¼	10 ¾	2	105	21	20
1 ½	8 ¼	12 ¼	2	153	23	15
2	9 ½	14 ½	2	210	21	10
2 ½*	10 ½	17 ¼	3	500	Bulk	Bulk
3*	13	22 ¾	3 ⅞	800	Bulk	Bulk
3 ½*	15	23 ¼	3 ¾	900	Bulk	Bulk
4*	16	23 ⅞	3 ⅞	1200	Bulk	Bulk
5*	24	34 ⅞	3 ⅞	2400	Bulk	Bulk
6*	30	45 ½	3 ¾	3800	Bulk	Bulk

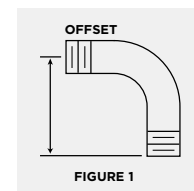

FIGURE 1

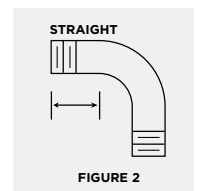

FIGURE 2

\* Trade sizes 2 ½ and larger shipped in palletized cartons or bulk. Palletized and bulk elbows supplied with a thread protector on each end and UL label affixed.

\*\* Minimum dimension per UL-6A.

# Rigid Aluminum Conduit

## SPECIAL LARGE-RADIUS 90° ELBOWS

TRADE SIZE	12" RADIUS	15" RADIUS	18" RADIUS	24" RADIUS	30" RADIUS	36" RADIUS	42" RADIUS	48" RADIUS
1	1	2	2	3	4	4	4	5
1¼	2	3	3	3	5	5	6	6
1½	3	3	4	4	6	6	7	8
2	4	3	4	5	8	8	9	10
2½	6	7	6	8	12	12	14	16
3	—	9	10	11	13	16	18	21
3½	—	Standard Radius	11	14	18	19	22	25
4	—	—	14	16	21	23	26	29
5	—	—	—	Standard Radius	29	34	37	44
6	—	—	—	—	Standard Radius	42	49	58

Numbers in table above represent weight in pounds of elbows we offer.

## NIPPLES

LENGTH		CLOSE		1½"		2"		2½"		3"		3½"	
TRADE SIZE	LENGTH* (IN.)	STD. CARTON QTY.	WEIGHT PER 100 (LBS.)	STD. CARTON QTY.	WEIGHT PER 100 (LBS.)	STD. CARTON QTY.	WEIGHT PER 100 (LBS.)	STD. CARTON QTY.	WEIGHT PER 100 (LBS.)	STD. CARTON QTY.	WEIGHT PER 100 (LBS.)	STD. CARTON QTY.	WEIGHT PER 100 (LBS.)
½	1⅛	25	2	25	3	25	4	25	5	25	7	25	8
¾	1⅜	25	3	25	3	25	5	25	7	25	8	25	10
1	1½	25	4	—	—	25	7	25	8	25	12	25	14
1¼	1⅝	25	7	—	—	25	10	25	13	25	16	25	20
1½	1¾	25	10	—	—	25	12	25	16	25	20	25	24
2	2	25	16	—	—	—	—	25	22	25	27	25	32
2½	2½	12	22	—	—	—	—	—	—	10	30	10	39
3	2⅝	12	24	—	—	—	—	—	—	10	42	10	53
3½	2¾	12	42	—	—	—	—	—	—	—	—	—	—
4	2⅞	12	51	—	—	—	—	—	—	—	—	—	—
5	3	Bulk	71	—	—	—	—	—	—	—	—	—	—
6	3⅜	Bulk	105	—	—	—	—	—	—	—	—	—	—

LENGTH		4"		5"		6"		8"		10"		12"		
TRADE SIZE	STD. CARTON QTY.	WEIGHT PER 100 (LBS.)	STD. CARTON QTY.	WEIGHT PER 100 (LBS.)	STD. CARTON QTY.	WEIGHT PER 100 (LBS.)	STD. CARTON QTY.	WEIGHT PER 100 (LBS.)	STD. CARTON QTY.	WEIGHT PER 100 (LBS.)	STD. CARTON QTY.	WEIGHT PER 100 (LBS.)	STD. CARTON QTY.	WEIGHT PER 100 (LBS.)
½	25	9	25	12	25	14	25	19	25	24	25	25	29	
¾	25	12	25	15	25	18	25	25	25	31	25	25	38	
1	25	16	25	21	25	26	25	36	25	45	25	25	55	
1¼	25	23	25	29	25	36	12	49	12	62	12	12	75	
1½	25	28	25	36	25	44	12	59	12	74	12	12	90	
2	25	38	25	48	25	58	12	78	12	100	12	12	120	
2½	10	47	12	64	12	80	5	114	5	148	5	5	180	
3	10	64	10	86	10	108	5	152	5	196	5	5	240	
3½	10	75	10	101	5	128	5	180	5	234	5	5	286	
4	10	87	10	118	5	149	5	212	5	274	5	5	336	
5	—	—	Bulk	155	Bulk	197	Bulk	281	Bulk	366	Bulk	Bulk	450	
6	—	—	Bulk	208	Bulk	263	Bulk	372	Bulk	481	Bulk	Bulk	591	

\* Length reference is for close nipples only.  
All dimensions provided are for descriptive purposes only.



**Tested and Listed for Safety**  
Our rigid aluminum elbows, couplings and nipples comply with the following standards:  
ANSI C80.5 and UL-6A, to which they are Listed.



9208 Jeffrey Drive  
Cambridge, OH 43725

800.PICOMA1  
info@picoma.com  
picoma.com



**Corporate Office**

227 West Monroe Street  
Suite 2600  
Chicago, IL 60606

312.275.1600  
info@zekelman.com  
zekelman.com

**About Picoma**

Picoma Industries, a division of Zekelman Industries, manufactures a complete line of electrical conduit fittings — galvanized elbows, couplings and nipples — and a complete EC&N package of aluminum, running thread and service meter masts.

For more information, contact Picoma at **800.PICOMA1** or **info@picoma.com**.  
Or, visit our website at [picoma.com](http://picoma.com)

**About Zekelman Industries**

Zekelman Industries includes the operating divisions of Atlas Tube, Picoma, Sharon Tube, Western Tube, Wheatland Tube and Z Modular. It is the largest independent manufacturer of hollow structural sections (HSS) and steel pipe, and the top producer of electrical conduit and elbows, couplings and nipples in North America. Zekelman Industries delivers a broad range of pipe and tube solutions that build its customers' success.