

## TYPE ASL

### Features

- Electro-tin plated
- Manufactured from high strength aluminum alloy
- Two sizes cover a wire range from 750 kcmil-1/0
- Unique design
- Versatile
- Suitable for use in circuits rated 35KV or less, proper high voltage spacing and insulation techniques must be used
- Rated to 90° C

### Benefits

- Provides low contact resistance
- Can be used with both aluminum and copper terminals
- Permits inventories to be kept to a minimum
- Allows vertical stacking to minimize space requirements
- Can be used with copper and/or aluminum connectors
- Application versatility

A

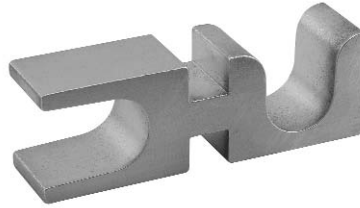
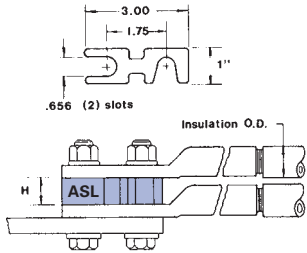

Catalog Number	Wire Range	Insulation O.D.	H
ASL-250	250kcmil-1/0	55/64	3/4
ASL-750	750kcmil-1/0	1-3/8	1-1/4

All wire sizes, unless noted otherwise, are American Wire Gauge (AWG)  
Tested to UL 486A/B, UL File E6207