

Project		Catalog #		Type	
Prepared by		Notes		Date	



# HALO

## SMD6 Series

6" Round and Square Surface Mount  
Downlight  
SMD6R & SMD6S

**Typical Applications**  
Residential

### Interactive Menu

- Order Information [page 2](#)
- Product Specifications [page 4](#)
- Photometric Data [page 5](#)
- Product Warranty

### Product Certification



Refer to ENERGY STAR® Certified Products List.  
Can be used to comply with California Title 24 High Efficacy requirements.  
Certified to California Appliance Efficiency Database under JAB.

### Product Features



### Top Product Features

- Ultra-low profile surface luminaire with wide distribution
- Ceiling or wall mounting in compatible junction boxes
- 600 & 1200 lumen; 2700K, 3000K, 3500K, 4000K or 5000K field selectable CCT; 90 CRI
- 120V only and Universal Voltage 120V – 277V options
- Dimmable with 120V dimmers

### Dimensional and Mounting Details

SMD6RXXXWH

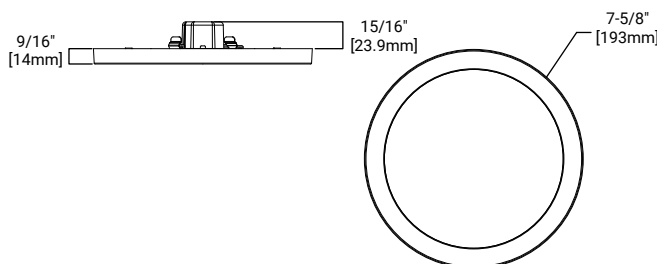

SMD6SXXXWH

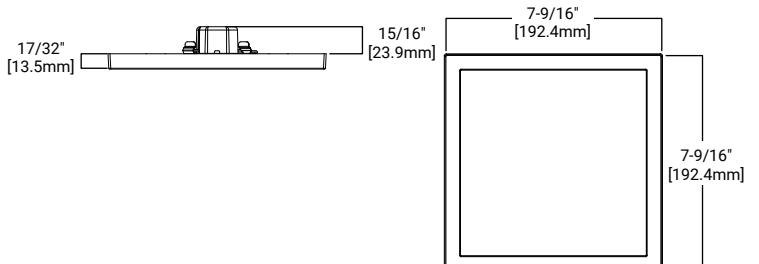

[additional product diagrams](#)

## Ordering Information

SAMPLE NUMBER: **SMD6R69SWH** = 6" Round Surface Mount Downlight, 600 lumen, 90CRI, Selectable CCT, White, 120V

**Junction Box Installation:** Order junction box separately, as supplied by others, to complete installation.

**Recessed Installation:** Order HALO recessed housing and SMD6ACCKIT separately to complete installation.

Models	Lumens	CRI/CCT	Finish	Voltage
<b>SMD6R</b> = 6" Round Surface Mount Downlight <b>SMD6S</b> = 6" Square Surface Mount Downlight	<b>6</b> = 600 lumen series (120V only) <b>12</b> = 1200 lumen series	<b>9S</b> = 90CRI, 2700K - 5000K Field Selectable CCT	<b>WH</b> = Matte White	<b>Blank</b> = 120V standard <b>E</b> = UNV Universal 120-277V <sup>(1)</sup>
<b>Notes</b>	<b>Notes</b>	<b>Notes</b>	<b>Notes</b>	<b>Notes</b> (1) UNV voltage configuration is offered only in the 1200 lumen series

## Accessories

Accessories
<b>Designer Trims</b> <b>SMD6RTRMSN</b> = 6" Round SMD Satin Nickel <b>SMD6RTRMTBZ</b> = 6" Round SMD Tuscan Bronze <b>SMD6RTRMWH</b> = 6" Round SMD White (paintable) <b>SMD6STRMSN</b> = 6" Square SMD Satin Nickel <b>SMD6STRMTBZ</b> = 6" Square SMD Tuscan Bronze <b>SMD6STRMWH</b> = 6" Square SMD White (paintable) <b>T24HWKIT</b> = Title 24 Cable harness kit used to convert incandescent and low voltage housings to LED <b>SMD6ACCKIT</b> = SMD6 accessory kit includes friction clips, torsion springs and a Edison screwbase adapter for recessed housing installation.
<b>Notes</b>

## Accessories

### Designer Trims



**SMD6RTRMWH**  
round, white (paintable)



**SMD6RTRMSN**  
round, satin nickel



**SMD6RTRMTBZ**  
round, tuscan bronze



**SMD6STRMWH**  
square, white (paintable)

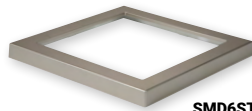

**SMD6STRMSN**  
square, satin nickel

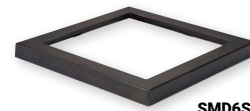

**SMD6STRMTBZ**  
square, tuscan bronze

## Junction Box Compatibility

**NOTE:** The SMD6 1200LM Series has a taller driver. The 4inch x 2-1/8 deep Square junction box is recommended for installation. The depth of the junction box must be a MINIMUM 2-1/8inch deep. The 4inch x 2-1/8 deep Octagon junction box can be used with limited number of wires or smaller gauge wires and wire caps.

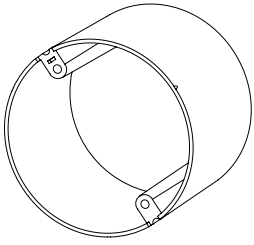

**Round**  
Recommend 2" depth  
(1-1/2" minimum)

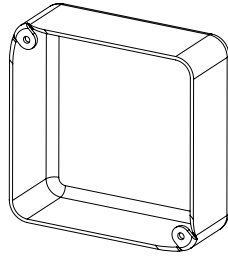

**Square**  
1-1/2" minimum depth

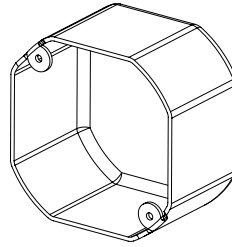

**Octagonal**  
Recommend 4" depth  
(2-1/8" minimum)

This is a representative list of compatible junction boxes only. Information contained in this literature about other manufacturers' products is from published information made available by the manufacturer and is deemed to be reliable, but has not been verified. Cooper Lighting Solutions makes no specific recommendation on product selection and there are no warranties of performance or compatibility implied. Installer must determine that site conditions are suitable to allow proper installation of the mounting bracket in the box.

## Dimensional and Mounting Details Continued

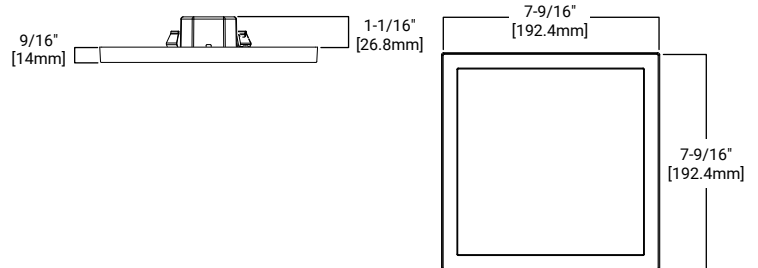
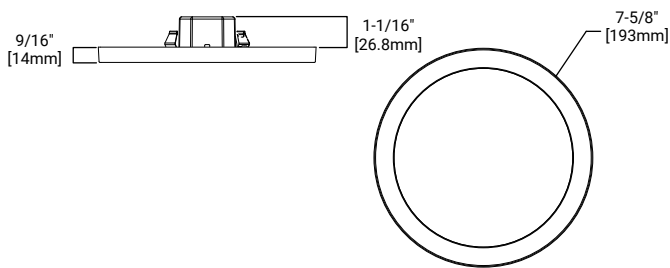

## Product Specifications

### Housing

- Non-electrically conductive polycarbonate frame.
- High impact diffuse polystyrene lens provides shielding to the light guide with no pixilation
- Stamped aluminum housing provides thermal cooling achieving L70 at 50,000 hours in IC and non-IC applications

### Gaskets

- Closed cell gasket achieves restrictive airflow and wet location requirements without additional caulking

### Optics

- Precision acrylic light guide organizes source flux into wide distribution with 1.2 – 1.4 spacing criteria useful for general area illumination

### LED

- Mid power LED array provide a uniform source with high efficiency and long life
- Available in 90 CRI minimum, R9 greater than 50 and color accuracy within 3 SDCM provide color accuracy and uniformity

### Driver

#### SMD 120V

- Integral 120V 50/60Hz constant current driver provides noise free operation
- Continuous, flicker-free dimming from 100% to 5% with select leading or trailing edge 120V phase cut dimmers
- Dimming to 5% is best assured using dimmers with low end trim adjustment. Consult dimmer manufacturer for compatibility and conditions of use. (Note some dimmers require a neutral in the wallbox.)
- Inline electrical quick connect and E26 adapter (provided) provides mains connections

#### SMD 120-277V

- Integrated 120-277V 60Hz constant current driver provides noise free operation
- SMD Universal Voltage (120-277V) configurations are recommended for use with compatible 0-10V DC
- low voltage dimmers only

### Mounting/Retention

- Adjustable spider plate allows for quick installation into both junction boxes and recessed housings
- Torsion springs and friction blades included

### Electrical Junction Box Mounting

- The SMD may be used in compatible electrical junction boxes in direct contact with insulation including spray foam insulation
- Suitable for installation in many 3-1/2" and 4" square, octagon, and round electrical junction boxes  
**Note:** SMD120-277V UNV is only compatible with junction boxes that provide minimum depth of 2-1/8"
- Installer must ensure compatibility of fit, wiring and proper mounting in the electrical junction box. This includes all applicable national and local electrical and building coded

### Recessed Housing Mounting

**Note:** Use the SMDACCKIT which includes torsion springs and Edison base adapter. (SOLD SEPERATELY)

- May be installed in IC recessed housings in direct contact with insulation

**Note:** Not for use in recessed housing in direct contact with spray foam insulation. Refer to NEMA LSD 57-2013

### Designer Skins (Sold Separately)

- SMD skins are accessory rings in both round and square. These skins attach to the SMD for a permanent finish. Refer to the SMD accessories specification sheet for details
  - Matte White (Paintable)
  - Satin Nickel
  - Tuscan Bronze

### Compliance

- cULus Certified for use with Halo housings and for use with other's housings, , when used with SMDACCKIT (Sold Separately) see instruction sheet for conditions of acceptability
- Wet and Damp Location listed, airtight per ASTM-E283
- Suitable for use in closets, compliant with NFPA® 70, NEC® Section 410.16 (A)(3) and 410.16 (C)(5)
- EMI/RFI emissions per FCC 47CFR Part 15B
- Contains no mercury or lead and RoHS compliant.
- Photometric testing in accordance with IES LM-79-08
- Lumen maintenance projections in accordance with IES LM-80-08 and TM-21-11
- Can be used for State of California Title 24 high efficacy luminaire compliance, reference the California Energy Commission Title 20 Appliance Efficiency Database for current listings
- Can be used for International Energy Conservation Code (IECC) and high efficiency luminaire compliance
- ENERGY STAR® listed, reference database for current listings

### Warranty

- Five year limited warranty, consult website for details. [www.cooperlighting.com/legal](http://www.cooperlighting.com/legal)

## Energy Data

### SMD6R6 / SMD6S6

	Round	Square
Lumens (5000K models)	777	800
Input Power	9 W	9 W
Input Current	0.085 A	0.085 A
Efficiency	86 lm/W	85 lm/W
THDi	8	8
Input Voltage	120V	
Frequency	60 Hz	
CRI	90 CRI	
Power Factor	0.98	
T Ambient	-30 - +40°C	
Sound Rating	Class A	

### SMD6R12 / SMD6S12

	Round	Square
Lumens (5000K models)	1271	1345
Input Power	15	15
Input Current	0.129 A	0.129 A
Efficiency	85 lm/W	88 lm/W
THDi	12.6	12.6
Input Voltage	120V	
Frequency	60 Hz	
CRI	90 CRI	
Power Factor	0.98	
T Ambient	-30 - +40°C	
Sound Rating	Class A	

### SMD6R12-E / SMD6S12-E

	Round	Square
Lumens (5000K models)	1357	1364
Input Power	14.5	14.5
Input Current	0.125 A (120V) 0.058 A (277V)	0.125 A (120V) 0.058 A (277V)
Efficiency	94 lm/W	94 lm/W
THDi	12.8	12.8
Input Voltage	120 - 277V	
Frequency	60 Hz	
CRI	90 CRI	
Power Factor	0.99 (120V) 0.94 (277V)	
T Ambient	-30 - +40°C	
Sound Rating	Class A	

## Photometric Data

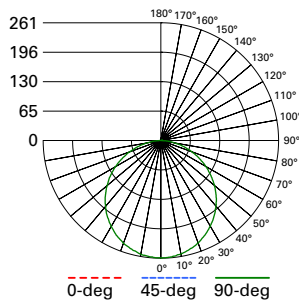

**SMD6R69SWH - 3000K.IES**  
 Spacing criterion: (0-180) 1.26  
 (90-270) 1.26  
 (Diagonal) 1.38  
 Beam Angle: 112°  
 Lumens: 757  
 Input Watts: 8.9 W  
 Efficacy: 85 LPW  
 Test Report:  
 SMD6R69SWH - 3000K.IES

Zonal Lumen	Lumens	% Lumens
0-30	201	26.6
0-40	330	43.6
0-60	585	77.4
0-90	752	99.4

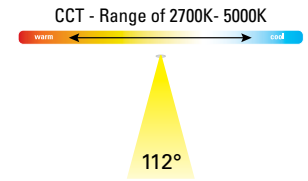

SMD6R69SWH	CCT	Watts	Lumens	LPW	CRI
600 Lumen 6" Round Selectable CCT	2700K	9.2	704	76.6	93
	3000K	9.2	716	77.8	93
	3500K	9.2	729	79.2	94
	4000K	9.2	742	80.5	94
	5000K	9.2	756	82.0	93

### PRODUCT SPECIFICATIONS

Lumens	716
Watts	9.2
Lumens Per Watt (Efficacy)	77.8
Color Accuracy (CRI)	93
Light Color (CCT) <small>Correlated Color Temperature (CCT)</small>	3000K

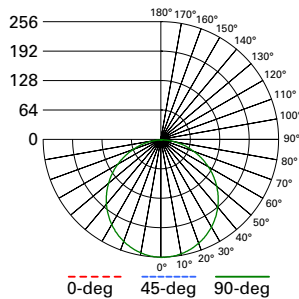

**SMD6S69SWH - 3000K.IES**  
 Spacing criterion: (0-180) 1.28  
 (90-270) 1.28  
 (Diagonal) 1.40  
 Beam Angle: 113°  
 Lumens: 752  
 Input Watts: 9.2 W  
 Efficacy: 82 LPW  
 Test Report:  
 SMD6S69SWH - 3000K.IES

Zonal Lumen	Lumens	% Lumens
0-30	199	26.4
0-40	326	43.4
0-60	580	77.2
0-90	748	99.5

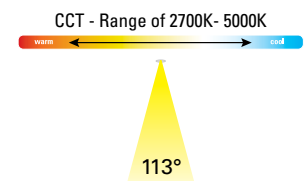

SMD6S69SWH	CCT	Watts	Lumens	LPW	CRI
600 Lumen 6" Square Selectable CCT	2700K	9.6	720	75.3	93
	3000K	9.6	735	76.7	93
	3500K	9.6	750	78.2	94
	4000K	9.6	764	79.5	94
	5000K	9.6	774	80.7	92

### PRODUCT SPECIFICATIONS

Lumens	735
Watts	9.6
Lumens Per Watt (Efficacy)	76.6
Color Accuracy (CRI)	93
Light Color (CCT) <small>Correlated Color Temperature (CCT)</small>	3000K

## Photometric Data

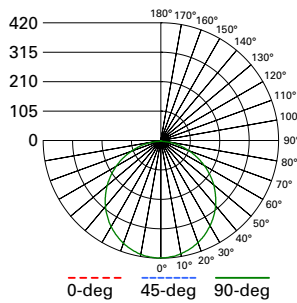

**SMD6R129SWH - 3000K.IES**  
 Spacing criterion: (0-180) 1.26  
 (90-270) 1.26  
 (Diagonal) 1.38  
 Beam Angle: 112°  
 Lumens: 1221  
 Input Watts: 14.9 W  
 Efficacy: 82 LPW  
 Test Report:  
 SMD6R129SWH - 3000K.IES

Zonal Lumen	Lumens	% Lumens
0-30	325	26.6
0-40	533	43.6
0-60	945	77.4
0-90	1215	99.5

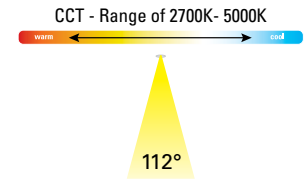

SMD6R129SWH	CCT	Watts	Lumens	LPW	CRI
1200 Lumen 6" Round Selectable CCT	2700K	15.2	1135	74.7	92
	3000K	15.2	1156	76.1	93
	3500K	15.2	1178	77.5	94
	4000K	15.2	1198	78.8	95
	5000K	15.2	1226	80.7	93

### PRODUCT SPECIFICATIONS

Lumens	1156
Watts	15.2
Lumens Per Watt (Efficacy)	76.1
Color Accuracy (CRI)	93
<b>Light Color (CCT)</b> <small>Correlated Color Temperature (CCT)</small>	<b>3000K</b>

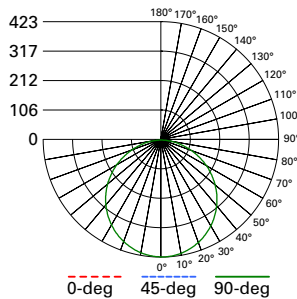

**SMD6S129SWH - 3000K.IES**  
 Spacing criterion: (0-180) 1.26  
 (90-270) 1.26  
 (Diagonal) 1.40  
 Beam Angle: 113°  
 Lumens: 1241  
 Input Watts: 14.9 W  
 Efficacy: 83 LPW  
 Test Report:  
 SMD6S129SWH - 3000K.IES

Zonal Lumen	Lumens	% Lumens
0-30	329	26.5
0-40	539	43.5
0-60	960	77.3
0-90	1237	99.6

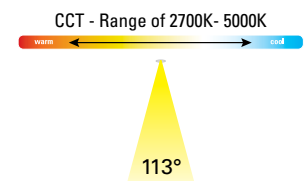

SMD6S129SWH	CCT	Watts	Lumens	LPW	CRI
1200 Lumen 6" Square Selectable CCT	2700K	15.5	1153	74.4	92
	3000K	15.5	1177	75.9	93
	3500K	15.5	1206	77.8	95
	4000K	15.5	1224	79.0	95
	5000K	15.4	1256	81.6	93

### PRODUCT SPECIFICATIONS

Lumens	1177
Watts	15.5
Lumens Per Watt (Efficacy)	75.9
Color Accuracy (CRI)	93
<b>Light Color (CCT)</b> <small>Correlated Color Temperature (CCT)</small>	<b>3000K</b>

## Photometric Data

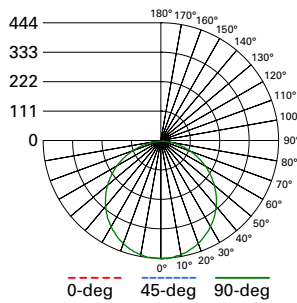

**SMD6R129SWHE - 3000K.IES**  
 Spacing criterion: (0-180) 1.24  
 (90-270) 1.24  
 (Diagonal) 1.38  
 Beam Angle: 112°  
 Lumens: 1289  
 Input Watts: 14.5 W  
 Efficacy: 89 LPW  
 Test Report:  
 SMD6R129SWHE - 3000K.IES

Zonal Lumen	Lumens	% Lumens
0-30	343	26.6
0-40	562	43.6
0-60	997	77.3
0-90	1282	99.5

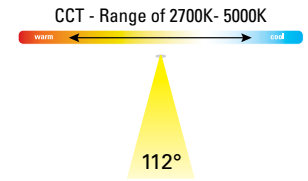

SMD6R129SWHE	CCT	Watts	Lumens	LPW	CRI
1200 Lumen 6" Round Selectable CCT 120-277V	2700K	14.7	1237	84.1	92
	3000K	14.7	1262	85.9	93
	3500K	14.7	1289	87.7	95
	4000K	14.7	1311	89.2	95
	5000K	14.7	1306	88.8	93

### PRODUCT SPECIFICATIONS

<b>Lumens</b>	<b>1262</b>
<b>Watts</b>	<b>14.7</b>
<b>Lumens Per Watt (Efficacy)</b>	<b>85.9</b>
<b>Color Accuracy (CRI)</b>	<b>93</b>
<b>Light Color (CCT)</b> <small>Correlated Color Temperature (CCT)</small>	<b>3000K</b>

warm white    soft white    bright white  
2700K    3000K    4500K    6500K

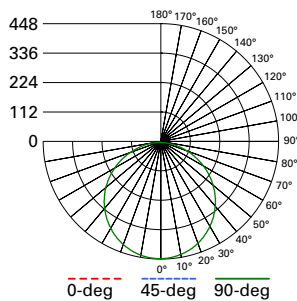

**SMD6S129SWHE - 3000K.IES**  
 Spacing criterion: (0-180) 1.26  
 (90-270) 1.26  
 (Diagonal) 1.40  
 Beam Angle: 114°  
 Lumens: 1312  
 Input Watts: 14.7 W  
 Efficacy: 89 LPW  
 Test Report:  
 SMD6S129SWHE - 3000K.IES

Zonal Lumen	Lumens	% Lumens
0-30	348	26.5
0-40	570	43.5
0-60	1014	77.3
0-90	1307	99.6

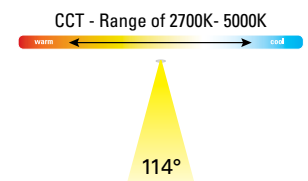

SMD6S129SWHE	CCT	Watts	Lumens	LPW	CRI
1200 Lumen 6" Square Selectable CCT 120-277V	2700K	15.1	1225	81.1	92
	3000K	15.1	1251	82.8	93
	3500K	15.1	1277	84.6	95
	4000K	15.1	1299	86.0	95
	5000K	15.1	1327	87.9	93

### PRODUCT SPECIFICATIONS

<b>Lumens</b>	<b>1251</b>
<b>Watts</b>	<b>15.1</b>
<b>Lumens Per Watt (Efficacy)</b>	<b>82.8</b>
<b>Color Accuracy (CRI)</b>	<b>93</b>
<b>Light Color (CCT)</b> <small>Correlated Color Temperature (CCT)</small>	<b>3000K</b>

warm white    soft white    bright white  
2700K    3000K    4500K    6500K