

Female Adapters

PVC Electrical Conduit Fittings and Accessories

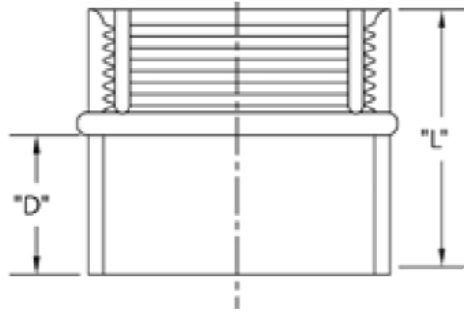

Trade Size (in)	Catalog Part Number	System Part Number	L	D
1/2	FA05	59630	1.438	0.688
3/4	FA07	59631	1.625	0.688
1	FA10	59632	1.875	0.875
1 1/4	FA12	59633	1.938	0.938
1 1/2	FA15	59634	2.125	0.938
2	FA20	59635	2.125	0.938
2 1/2	FA25	59636	3.000	1.313
3	FA30	59637	3.063	1.250
3 1/2	FA35	59638	3.000	1.188
4	FA40	59639	3.250	1.375
5	FA50	59640	3.688	1.313
6	FA60	59641	4.375	1.625
8	FA80	59642	7.000	2.250

- Dimensions are nominal (inches) and are subject to normal manufacturing tolerances
- All sizes conform to UL 651 and NEMA TC-3
 - UL651 does not include 8"